

manual de mantenimiento
operador Activa+

maintenance manual
Activa+ operator

manuel de maintenance
opérateur Activa+

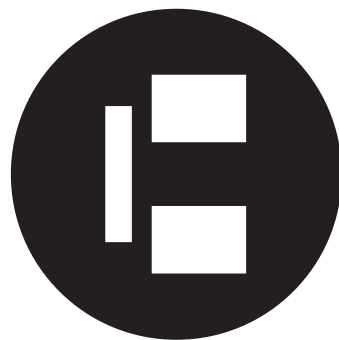
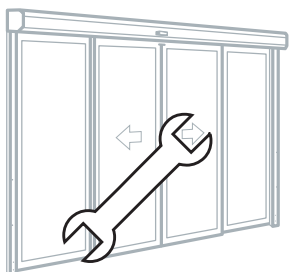

manusa

Puertas automáticas

Maintenance Manual

Automatic Door with Bravo Operator

1- INTRODUCTION

This manual contains instructions for the maintenance of manusa automatic doors, Activa+ model.

NOTES:

- 1.-All maintenance operations, except functional tests, should be carried out in "open door" mode and with the power supply disconnected. The outside key switch should not be handled in these operations, as the engine could be triggered by the fail-safe battery mechanism.
- 2.-If the power supply cable is damaged, it should be replaced by a special cable or kit supplied by the manufacturer or by the post-sale service.
- 3.-The batteries contained in the mechanism must be removed before its disposal.

2- MAINTENANCE INTERVALS

There are two types of maintenance intervals:

a.- By Time lapsed. T



b.- By number of Cycles. C

| | | | | | |
|---|---|---|---|---|---|
| 0 | 4 | 7 | 8 | 3 | 8 |
|---|---|---|---|---|---|

2a- TIME INTERVALS

T-1 EVERY 6 MONTHS

a.- Cleaning of trolleys and rollers:

Use a cloth, lightly dampened with trichlorethylene.

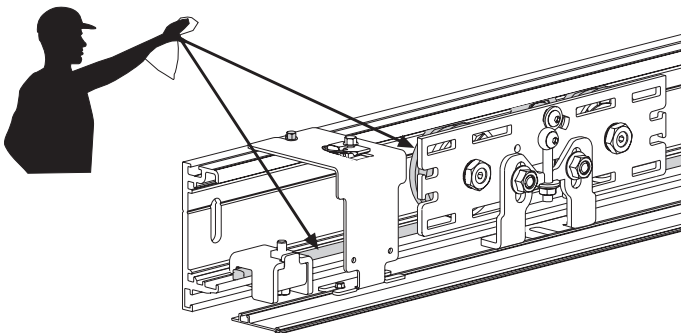

b.- Eccentric roller test:

The rollers should rotate freely. Check the tightness of the rollers, and readjust if necessary.

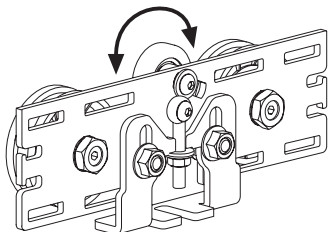

c.- Detection elements test:

- Check there are no dead angles near the sliding leaves.

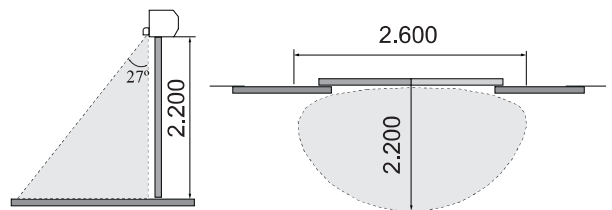

- Check that the detectors are correctly fixed.



d.- Photoelectric barrier test.

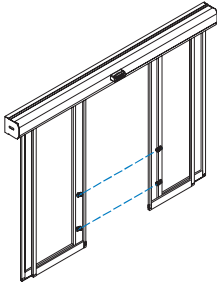

e.- Trolley hanger lock test.

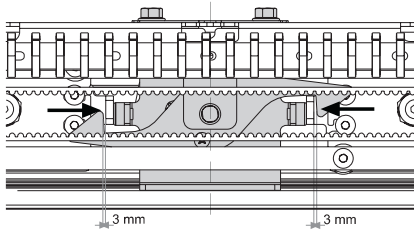

f.- Panic break-out system test.

- Disconnect power supply and check that the electrical or intrinsic mechanical power panic break-out system's leaves open fully.

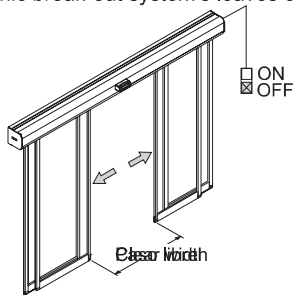

T-2 EVERY 24 MONTHS

a.- Change the brush strips and central sealing gaskets.

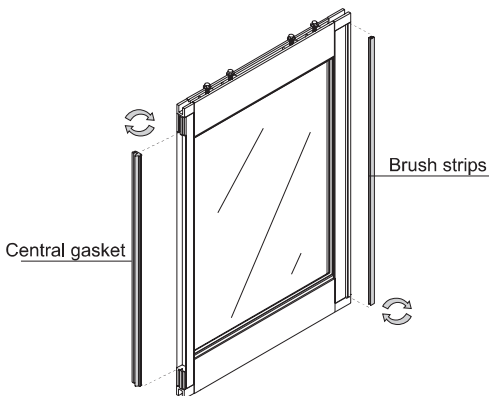

T-3 EVERY 48 MONTHS

a.- Replace fail-safe batteries.

Disconnect the device from the power supply before removing the batteries. The batteries must be destroyed following safety procedures.

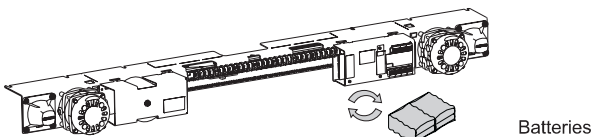

2b- NUMBER OF CYCLE INTERVALS

C-1 EVERY 500,000 CYCLES

a.- Replace the rubber end stops in the trolleys.

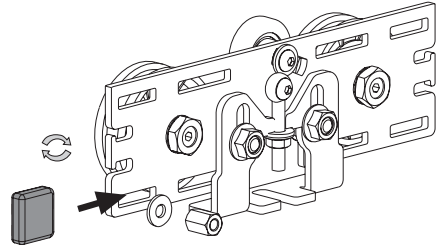

b.- Replace the CO-48 elastic.

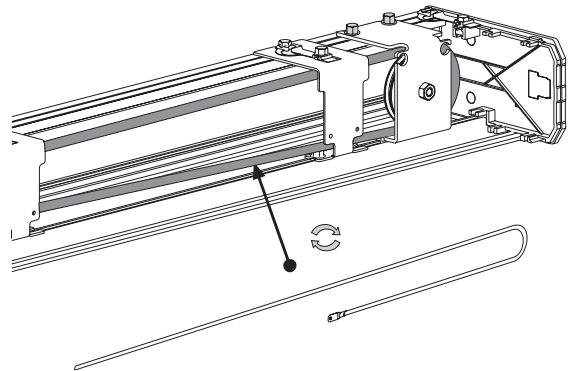

c.- Replace the CO-48 rubber stop.

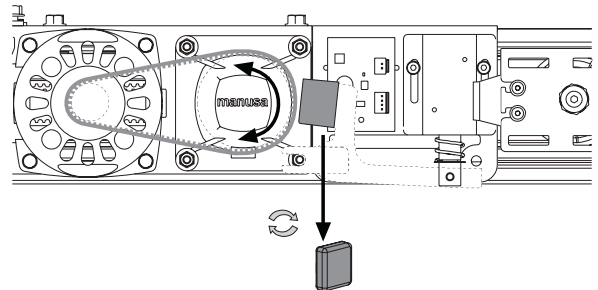

C-2 EVERY 1,000,000 CYCLES

a. Replace the guides on leaf-types T20, D20 and E20.

T20

D20

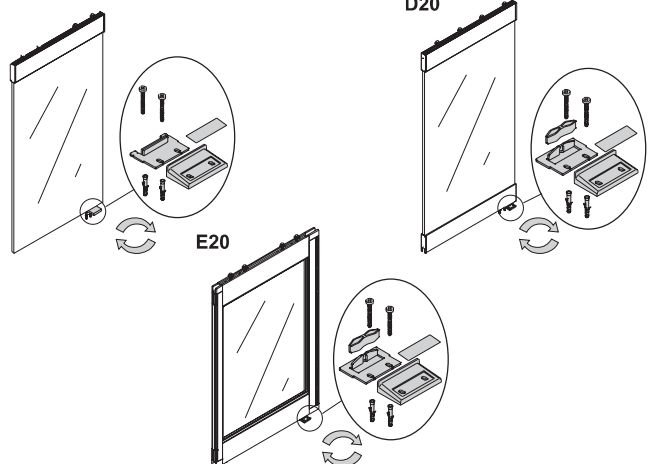

047838 C-3 EVERY 2,500,000 CYCLES

a.- Dismantle the motor group.

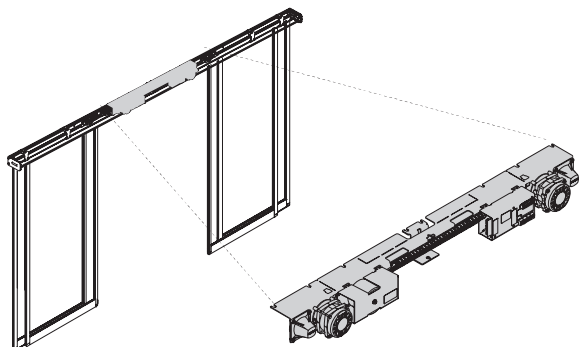

b.- Dismantle and replace the motor release pistons

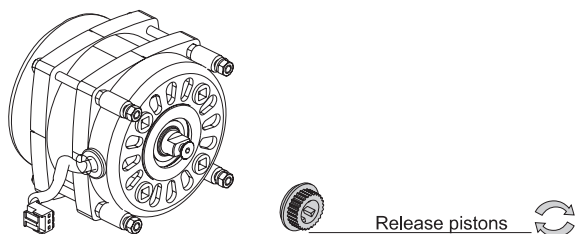

c. - Replace the belts.

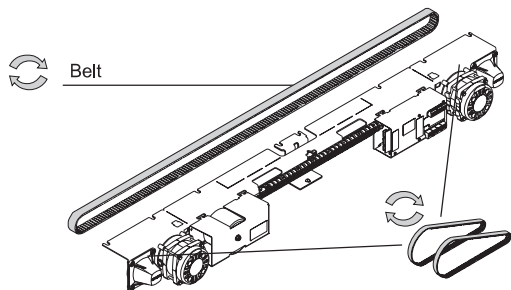

d.- Replace the concentric and excentric rollers.

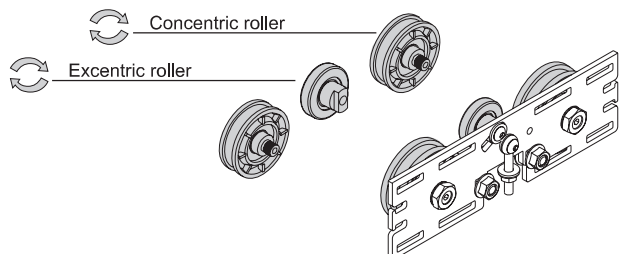

047838 C-4 EVERY 5,000,000 CYCLES

a.- Replace roller profiles.

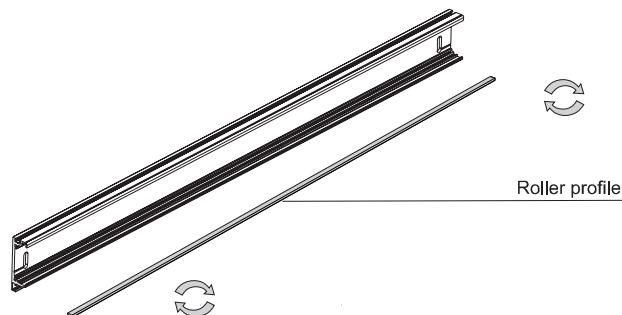

NOTE: The technical specifications described in this manual are given for information purposes only, and do not represent any contractual obligation for Manusa.

Manusa reserves the right to modify in any moment and without prior notice the technical specifications displayed in this manual, whenever it is considered to improve the product.

Last revision: September 2005

manusa 

Automatic doors

HEAD OFFICE
Edif. TESTA-10, 4º
Avda. Vía augusta, 71-73
08174 Sant Gugat del Vallés
Barcelona - España
Tel. +34 902 321 400
Fax +34 902 321 450

FACTORY
Polígono Industrial Km. 1,2
43800 Valls - Tarragona (España)
Tel. +34 902 321 700
Fax +34 902 321 750
www.manusa.com